

Civil Engineering

KFW is a multi-disciplinary firm that specialises in Project Management, Surveying, Civil Engineering, Structural Engineering, Sewer & Water Design, Sewer & Water Co-ordination and Urban Development.

The firm commenced operation in 1949 as Consulting Surveyors and by 1989 had diversified into Consulting Engineering and Urban Development Services. KFW has successfully grown to be the largest locally owned multi-disciplinary consultancy in the Illawarra.

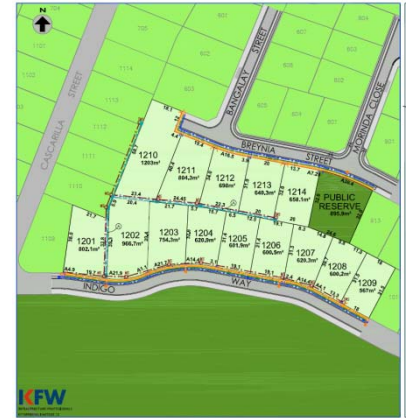

KFW Civil Engineers and Design Draftspersons offer services to the **Land Development** Community in areas such as subdivision design, flood studies, drainage design and Traffic Engineering. We strive to provide creative engineering solutions giving client security and certainty of asset performance.

Civil Works

- Earthworks design and volume calculation
- Dam and waterway designs
- Quarry and general topographical design
- Industrial layouts
- Carpark design
- Turning Movements and Geometrical design of difficult layouts
- Feasibility Studies and advice
- Waste Facility Design and Resource Recovery Facility Advice

Land Subdivision

- Subdivision layout and design
- Road and Driveway design
- Urban drainage design
- Local lot drainage layouts

Flood Studies

- Catchment hydrology and design flows
- Water Sensitive Design
- Innovative Water Reuse Design
- Bioretention systems
- Two-Dimensional flood studies for large developments

